

Contents

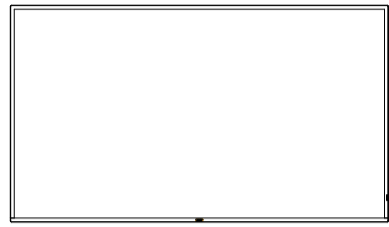

LCD Display

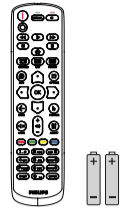

Remote Control and AAA Batteries



Quick Start Guide

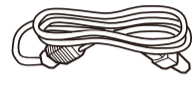

Power Cord

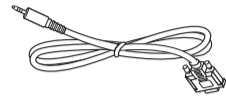

RS232 Cable

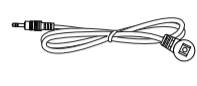

IR Sensor Cable



Philips Logo Plate

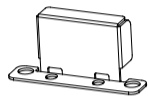

AC Switch Cover x 1



Dipole Antenna x2PCS

* Differences according to regions.
Display design and accessories may differ from those illustrated above.



1 Unboxing

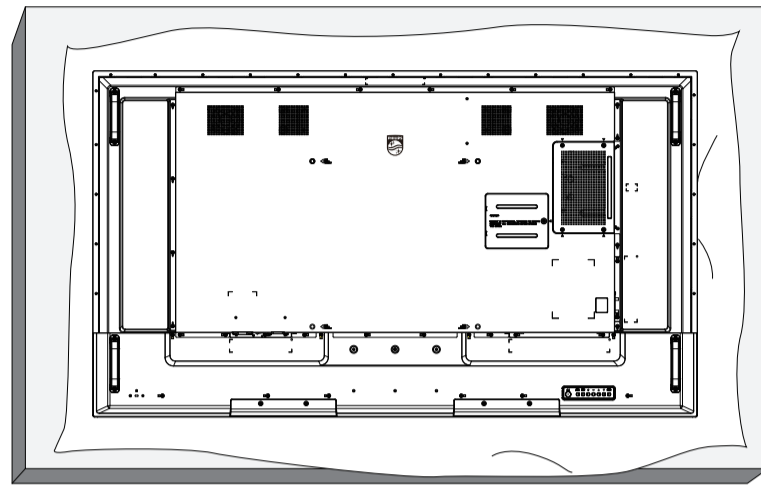

2 Control Panel

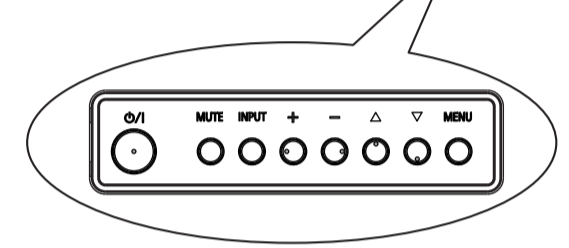
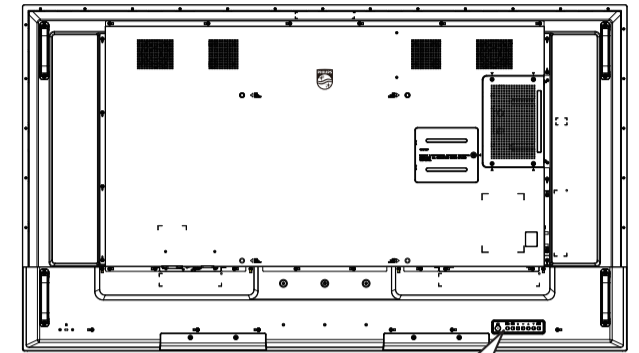

3 Input/Output Terminals

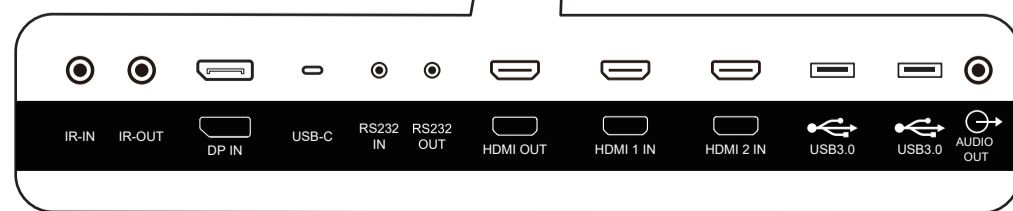
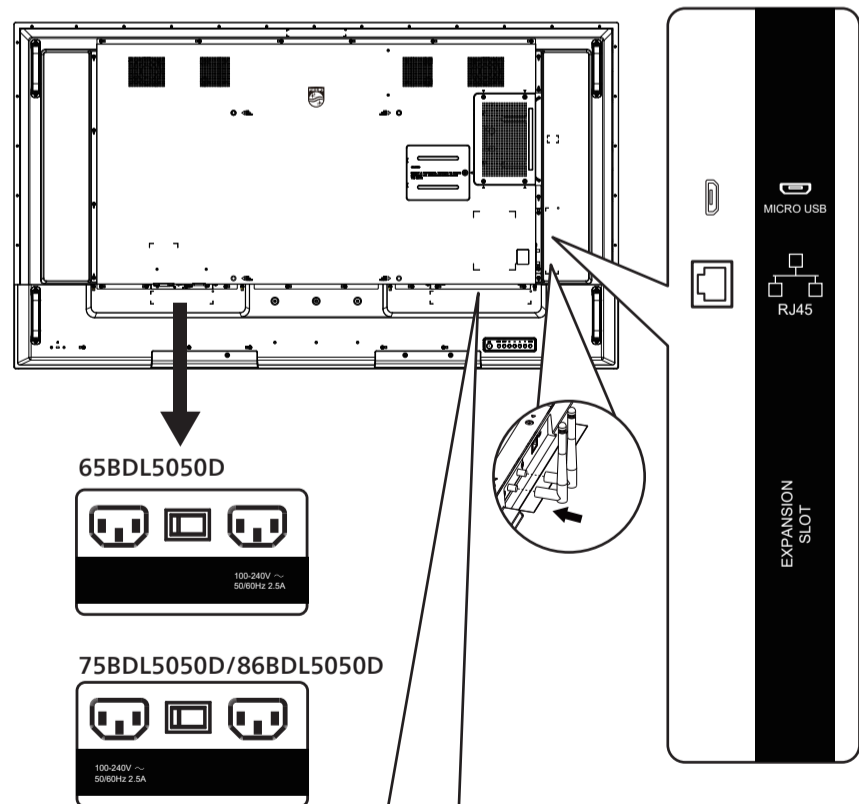

4 Connection

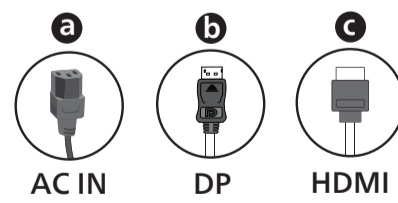
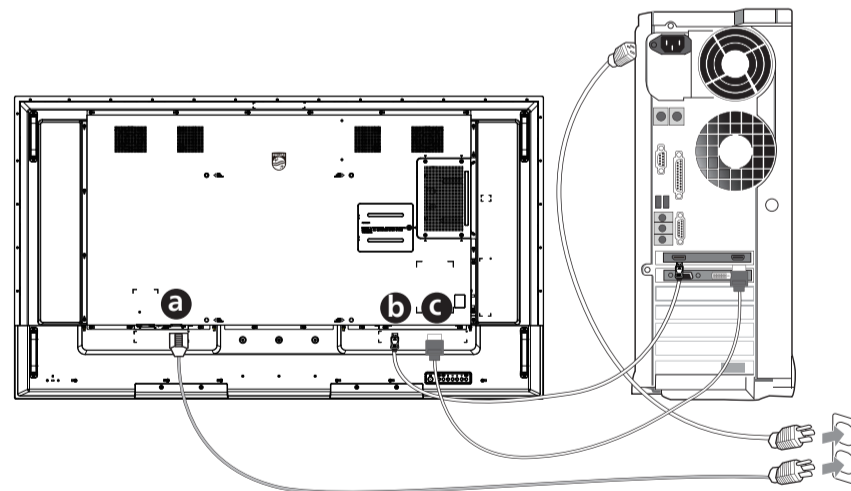

5 Installation

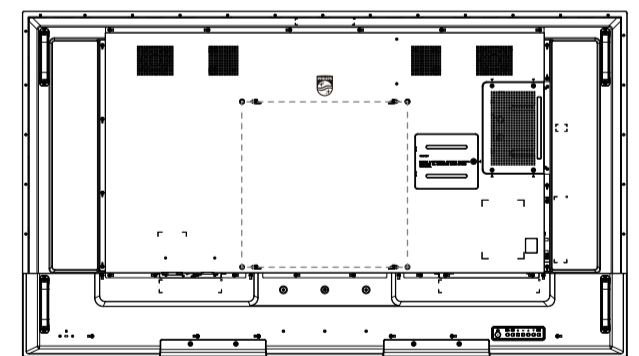
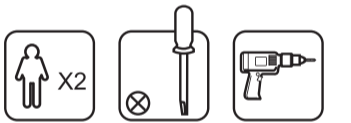

⚓ M8* (15+X) mm
(X=Thickness of Wall Mount BKT)

65BDL5050D: 400mmx400mm
75BDL5050D: 600mmx400mm
86BDL5050D: 600mmx400mm

6 Mounting in Portrait Orientation

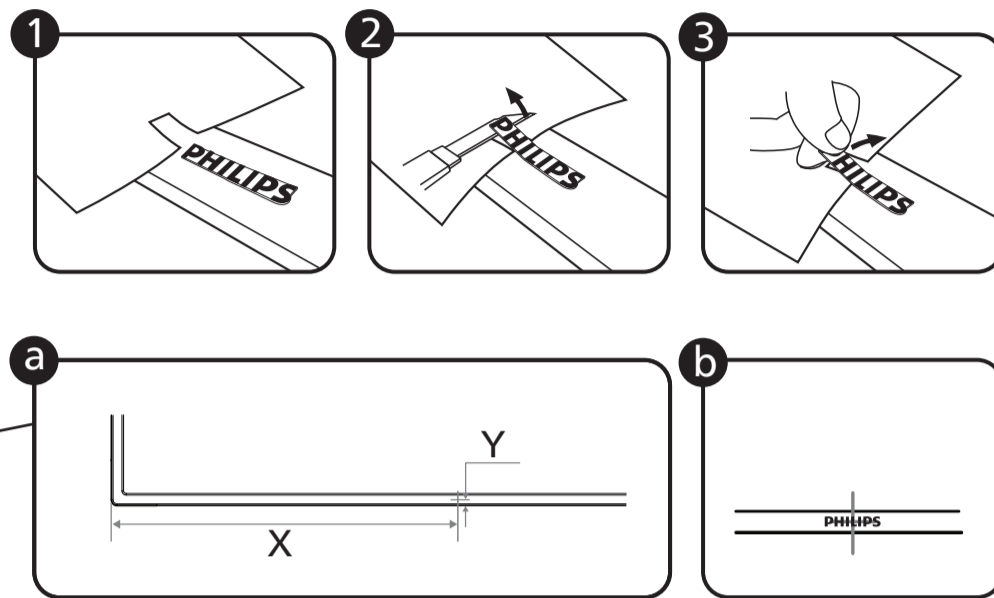
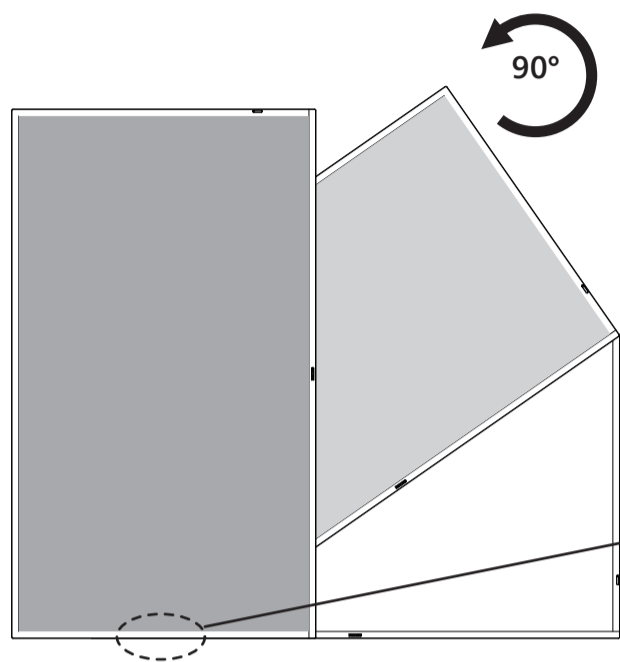

65BDL5050D: X=418.7mm Y=7.9mm
 75BDL5050D: X=480.9mm Y=7.9mm
 86BDL5050D: X=550.0mm Y=8.2mm

PHILIPS

Signage Display

5000 Series

65BDL5050D
 75BDL5050D
 86BDL5050D

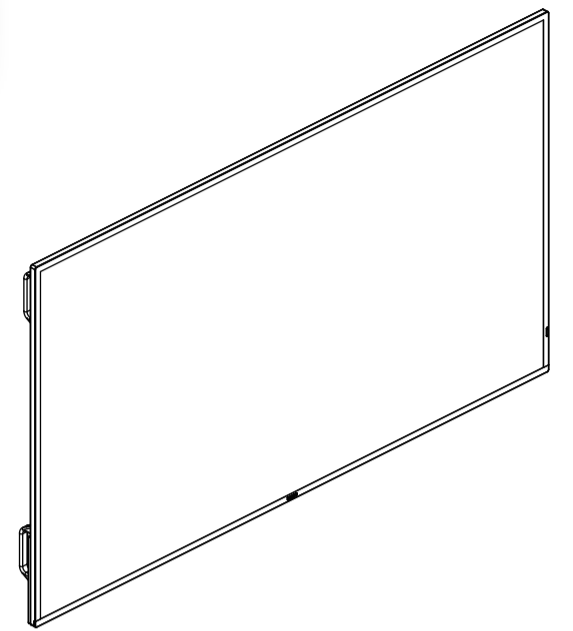

Quick start



For more information, please visit:
<https://www.philips.com/ppds>



Version: V1.00 2025-09-10

TPV USA Corp
 6525 Carnegie Blvd #200
 Charlotte, NC 28211
 USA

EU Energy Labelling



65BDL5050D



75BDL5050D



86BDL5050D

2025 © TOP Victory Investments Ltd. All rights reserved.

This product has been manufactured by and is sold under the responsibility of Top Victory Investments Ltd., and Top Victory Investments Ltd. is the warrantor in relation to this product. Philips and the Philips Shield Emblem are registered trademarks of Koninklijke Philips N.V. and are used under license.

Specifications are subject to change without notice.



Q41G75M181361A